

## Audio/Video Cable Connections

### C Connecting to a MONO TV or VCR (No Stereo Sound)

Make sure to plug the Audio/Video Cable into the "INPUT" connections of your TV or VCR (Do not use connections labeled "OUTPUT").

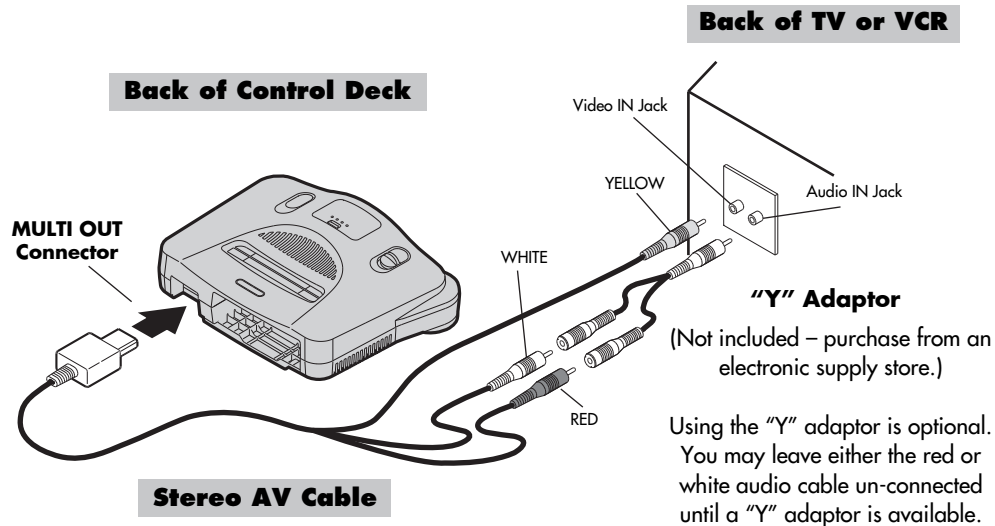

When using this connection, you will need to locate the INPUT SELECT on your TV and/or VCR or remote in order for the game to appear on your screen (see complete details on page 11).

## RF Switch/RF Modulator Connections

### D Connecting to a TV Without Audio/Video Connections

*NOTE: This method of connection will produce mono sound only (the left and right stereo channels will be mixed).*

**If your TV or VCR does not have audio/video connections,** you will need to use a Nintendo 64 RF Switch and RF Modulator (sold separately), to complete your connections.

You can purchase the Nintendo 64 RF Switch and RF Modulator (packaged together as a set) from most retail stores where Nintendo products are sold, or see the parts list and order form on page 20 in this booklet.

*Note: Be sure to use only the Nintendo 64 RF Switch and RF Modulator displaying the Official Nintendo Seal of Quality to ensure the highest picture quality.*

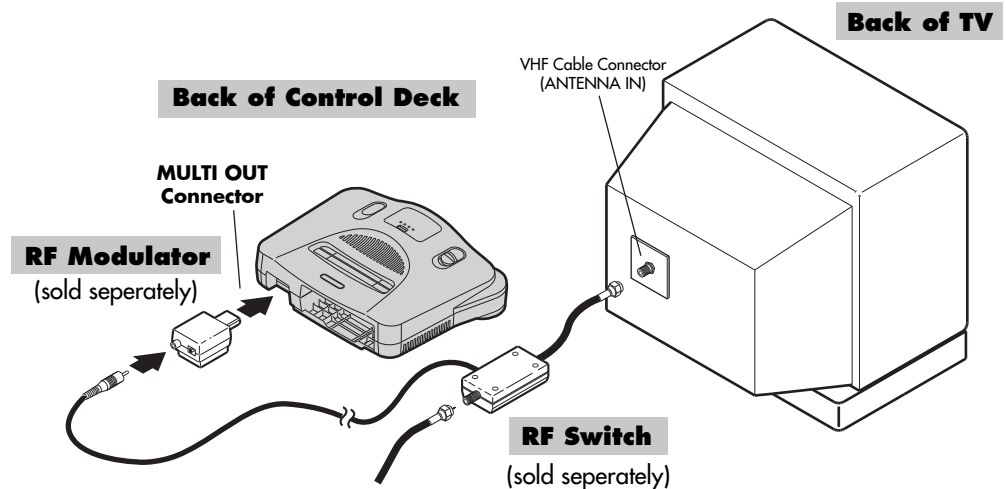

Remove the existing cable connected to the back of your TV and reconnect it to the RF Switch as shown.